

# Turbine Vibrators

## BVS SERIES

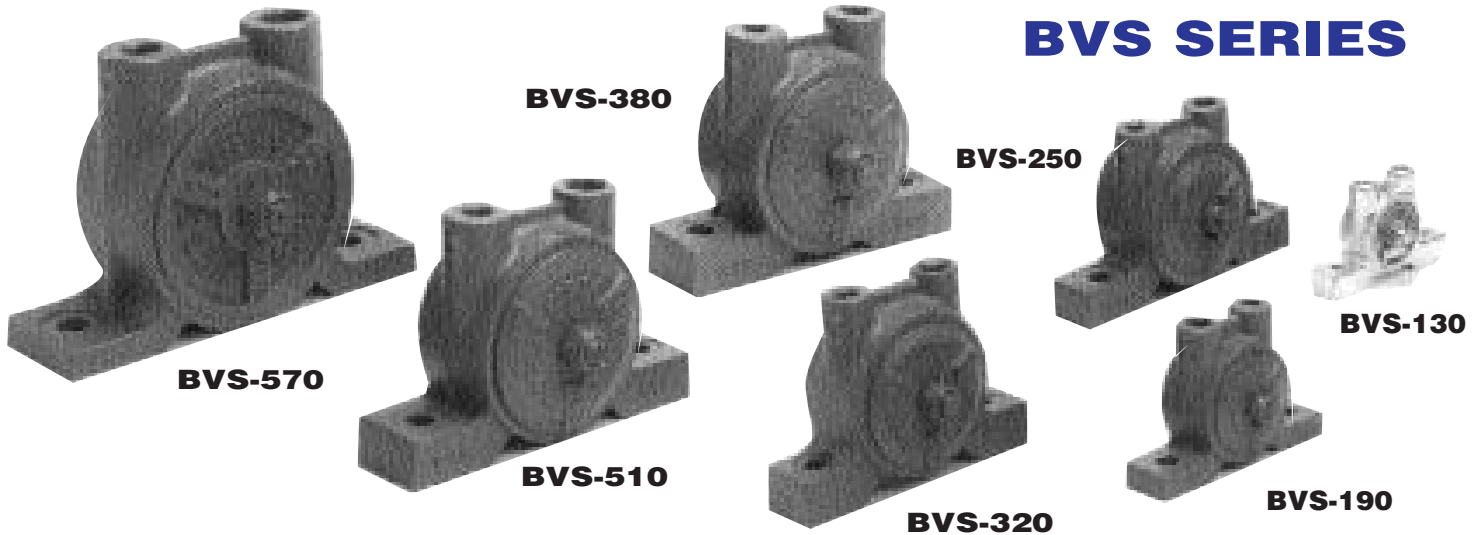

### MODEL BVS: THREADED EXHAUST

VIBCO offers 10 models in the extra heavy duty BVS series. The use of non-lubricated air supply makes the BVS turbine vibrators perfect for applications in food and pharmaceutical (etc.) industries where oil exhaust would be objectionable. Exhaust port is threaded for piping off of air exhaust in closed, sanitized systems. Extra large amplitudes and wide range of sizes makes the BVS's ideal for quickly moving parts or materials.

- Quiet, Meets OSHA Low As 68 dB At 1 Meter
- No Lubrication Required
- Easily Repaired - One Moving Part
- Patented Design
- High Force Output
- Out Lasts Piston Vibrators 3 to 1
- Oversized Bearings

### TECHNICAL DATA

Model	Weight***		60 PSI		80 PSI					Max. Lbs.** Material In Bin
	lbs.	kg.	Speed VPM	CFM	Speed VPM	CFM	lbs. Force	N*	dB*	
BVS-60	7/13 oz.	.198/.368	12000	4			20	89	66	200
BVS-130	10/20 oz.	.283/.567	8000	4.5	10500	5.5	75	334	67	750
BVS-160	2	.9	9500	7	11000	8	160	712	70	1600
BVS-190	3	1.4	5500	7.5	7200	8.5	270	1201	71	2700
BVS-250	5	2.3	5200	8	7200	9	480	2136	72	4800
BVS-320	8.5	3.9	5500	9	6800	10	600	2669	70	5300
BVS-380	13	5.8	4500	16	5000	18	670	2981	74	6700
BVS-440	17	7.7	4300	18	4800	21	700	3114	76	7000
BVS-510	18	8.2	4000	18	4500	21	900	4004	77	9000
BVS-570	25	11.3	3600	21	4000	26	1050	4671	83	10500

Data obtained on Laboratory test block. Frequency and force will decrease on less rigid mount. Data subject to design changes.  
 \* Decibel from A-scale at 1 meter and 80 PSI. N = Centrifugal force in Newton.  
 \*\* Rule of thumb for sizing "One lb. Vibrator Force" to each 10 lbs. of Bin Content" at 80 PSI.  
 \*\*\* Fist Figure Aluminum 2nd - malleable iron.

### DIMENSIONS

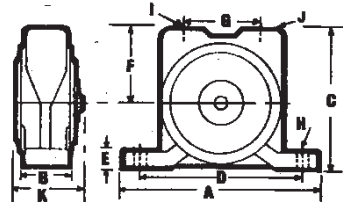

Model	A inch/mm	B inch/mm	C inch/mm	D inch/mm	E inch/mm	F inch/mm	G inch/mm	H** inch/mm	I* inch/mm	J* inch/mm	K inch/mm
BVS-60	3/8 98	3/4 19	2 5/8 60	3 76	5/8 16	1 1/4 32	1 1/4 32	1/4 6	1/8 - NPT	1/8 - NPT	1 1/16 30
BVS-130	4 7/8 124	7/8 22	2 3/4 70	4 102	3/4 19	1 7/16 37	1 7/16 37	3/8 10	1/8 - NPT	1/4 - NPT	1 7/8 48
BVS-160	5 3/16 139	1 1/4 32	3 7/16 81	4 102	7/8 22	1 3/4 44	1 7/8 48	3/8 10	1/4 - NPT	3/8 - NPT	2 3/4 70
BVS-190	5 3/16 139	1 1/4 32	3 7/16 81	4 102	7/8 22	1 3/4 44	1 7/8 48	3/8 10	1/4 - NPT	3/8 - NPT	3 1/16 78
BVS-250	6 3/4 171	1 5/16 33	3 15/16 100	5 127	7/8 22	2 3/16 56	2 1/8 54	1/2 12	1/4 - NPT	3/8 - NPT	3 1/8 79
BVS-320	6 1/2 165	1 5/8 41	4 7/8 124	5 127	1 1/8 29	2 3/4 70	2 3/4 70	1/2 12	3/8 - NPT	1/2 - NPT	4 102
BVS-380	7 7/8 200	1 7/8 48	5 1/16 138	6 152	1 1/8 29	2 13/16 71	2 7/8 73	5/8 16	3/8 - NPT	1/2 - NPT	4 5/8 117
BVS-440	8 13/16 224	2 13/16 56	5 3/4 146	7 178	1 1/4 32	3 1/16 87	3 1/8 79	5/8 16	1/2 - NPT	3/4 - NPT	4 3/4 121
BVS-510	8 13/16 224	2 13/16 56	5 3/4 146	7 178	1 1/4 32	3 1/16 87	3 1/8 79	5/8 16	1/2 - NPT	3/4 - NPT	4 3/4 121
BVS-510F	3 7/8 224	3 3/16 81	5 3/4 146	7 178	1 1/4 32	3 7/16 87	3 3/8 79	1/2 14	1/2 - NPT	3/4 - NPT	4 3/4 121
BVS-570	10 1/16 256	2 7/8 73	7 178	8 203	3/4 19	4 1/8 105	3 13/16 97	3/4 19	3/4 - NPT	1 - NPT	5 5/8 137

\*NPT Pipe Tap Size \*\*Bolt Size